

1. Mechanical Outline (Unspecified Tolerances is: ± 0.2)  
结构尺寸(未标注尺寸公差)

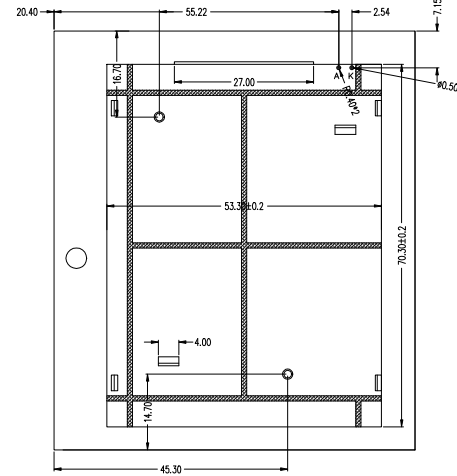

- 5.技术要求:
1. CRITICAL DIMENSION(重要尺寸).
  2. REFERENCE DIMENSION(参考尺寸).
  3. RoHS COMPLIANCE(RoHS制程).
  4. Single LGP+RUBBER FRAME(导光板+胶框结构)
  5. Operating Temperature:(工作温度): -20°C ~ 70°C, Storage Temperature:(储存温度): -30°C ~ 80°C,
  6. Wire welding is firm(引线焊接牢固).

6. Test Point(测试点):
1. Test Instrument(测试仪器): BM-7
  2. Test Distance(测试距离): 500 mm
  3. Aperture Diameter(光圈直径): Ø7.7

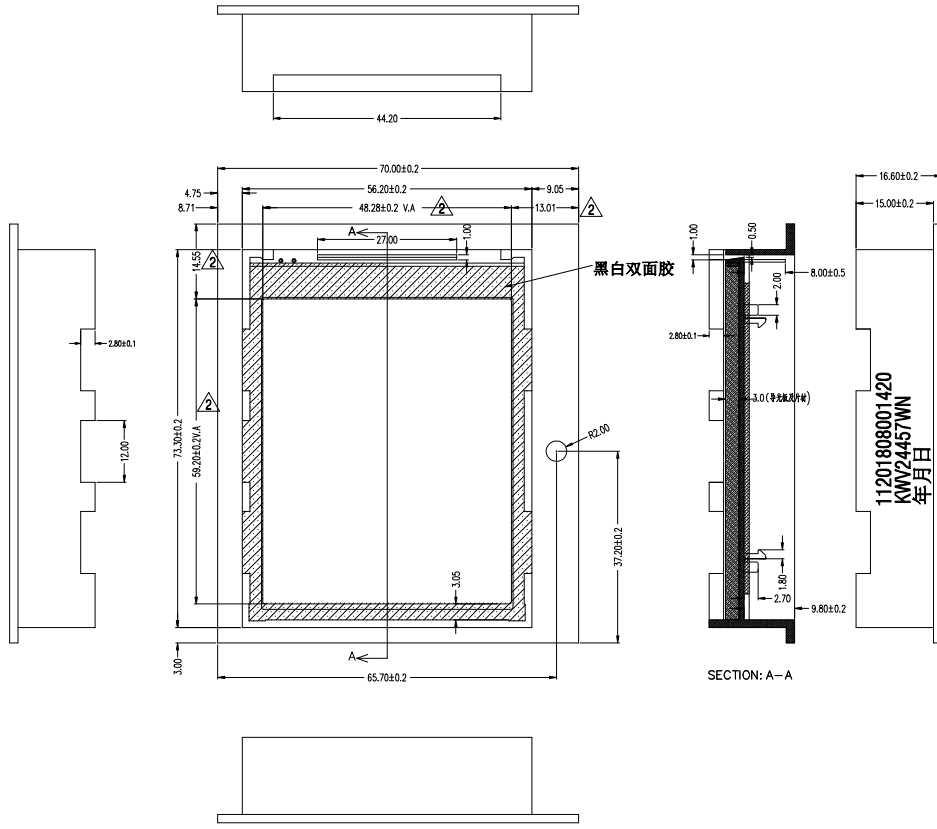
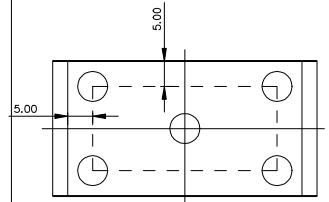

2. Electrical-Optical Characteristics (光电特性参数)

| 项目 Item  | 符号 Symbol | 最小值 MIN. | 典型值 TYP. | 最大值 MAX. | 单位 Unit           | 测试条件(Ta=25°C) Condition       |
|--|-----------|----------|----------|----------|-------------------|-------------------------------|
| 正向电流 Forward Current                           | If        | -        | 75       | 100      | mA                | Vf=5.0 V                      |
| 色度坐标 Colour Coordinate<br>(Tolerance is ±0.01) | X         | 0.26     | -        | 0.32     |                   |                               |
|  | Y         | 0.26     | -        | 0.32     |                   |                               |
| 亮度 Luminance                                   | Lv        | 1600     | -        | -        | cd/m <sup>2</sup> | TEST INSTRUMENT<br>确定仪器: BM-7 |
| 均匀度 Uniformity                                 | Avg       | 80       | -        | -        | %                 |                               |
| 反向电流 Reverse Current (Per LED)                 | Ir        | -        | -        | 10       | uA                | Vr=5 V                        |

3. 极限参数 ABSOLUTE MAXIMUM RATINGS

(除非特别说明,否则环境温度 Ta=25°C)

| 项目 Item                                      | 符号 Symbol       | 条件 Conditions                                     | 值 Rating | 单位 Unit |
|--|-----------------|---|----------|---------|
| 封装直流正向电流<br>Absolute maximum forward current | I <sub>fm</sub> |   | 125      | mA      |
| 脉冲驱动时最大正向电流<br>Peak forward current          | I <sub>fp</sub> | 1 msec 脉冲, 1/10 占空比<br>1 msec Plus 10% Duty Cycle | 375      | mA      |
| 反向电压<br>Reverse Voltage                      | V <sub>r</sub>  |   | 5        | V       |
| 封装功耗<br>Power dissipation                    | P <sub>d</sub>  |   | 2'225    | mW      |

4. Circuit Diagram

(LED 5 SMDS )Color:WHITE

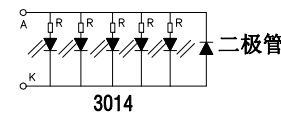

|                                  |             |                   |     |
|----------------------------------|-------------|-------------------|-----|
| 产品型号(MODEL NO):                  | RHL1510A-05 | REV: 版本 A0        |     |
| 客户型号(CUSTOMER'S NO):             | KWW24457WN  | REV: 版本           |     |
| 单位(UNIT)                         | 毫米(mm)      | 比例(scale)         | FIT |
| 第三视角<br>(THIRD ANGLE PROJECTION) |             | 第1张 共1张<br>(1OF1) |     |
| 设计(DESIGN):                      |             |                   |     |
| 检查(CHECKED):                     |             |                   |     |
| 批准(APPROVED):                    |             |                   |     |

鑫美芝实业有限公司